



## EP71

### Product name

Earth Positive® Premium Shopper Tote Bag

### Fibre composition / Yarn type

100% GOTS Organic Cotton Compact Spun

### Fabric type / Weight

Plain weave 5 oz/yd<sup>2</sup> 170 g/m<sup>2</sup>

### Commodity code

4202 9291 10

### Origin

India

### Available sizes

One Size

### Certifications



### Available colours



Black  
BL



Natural  
(Undyed)  
NL

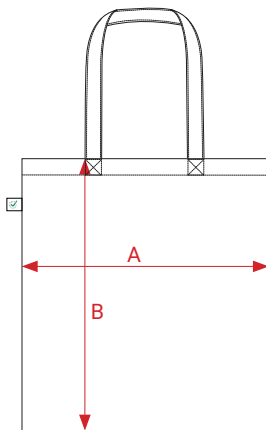

### Size spec

Size	Width (A)		Length (B)	
	cm	inch	cm	inch
One Size	38	15	42	16½

# EARTH POSITIVE



## Discharge printing suitability

Important: This guide serves as a general reference, and results may vary. We strongly recommend testing prior to production.

### Core colours

	Very Good	Moderate	Not Suitable
 <b>Black</b> BL	✓		

### Solid colours

	Very Good	Moderate	Not Suitable
 <b>Natural</b> NL			✓

## Printing Guide

Print type	Print type	Printing suitability 0 = Not Suitable, 1 = Poor, 2 = Moderate, 3 = Good, 4 = Very Good, 5 = Excellent	Printing recommendations
Twill Weave & Plain Weave 100% Organic Cotton Solid Colours	Screen print	★★★★☆	Follow manufacturer's recommendations for printing and curing settings.
	Discharge	★★★★☆	The results may vary from one colour to another. Refer to our discharge printing recommendations on the following page.
	Transfer (Sticker)	★★★★★	Follow manufacturer's recommendations for curing settings.
	Direct to garment	★★★★☆	Follow manufacturer's recommendations for printing and curing settings.
	Embroidery	★★★★★	Direct embroidery, stitched patch, labels

\*Maximum heat recommendation for back neck label 90°C / 60 sec